



**\*40 to 85  
l/min**

**230  
VAC  
or  
12/24  
VDC**



**IDENTIFICATION:**  
through PIN code or  
identification key

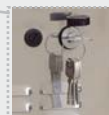

**Manual mode** through  
key in order to supply in  
an emergency case



**Possibility of connecting  
the kits to a computer**



**Optional**

Hexagonal base (1 m) code 800400015

The compact supply kits with controller are suitable for the diesel own consumption supply, measuring and control for fleet vehicles.

**Composed of:**

- Chassis made of steel. Finished with brilliant epoxy paint with special interior and exterior treatment against corrosion. Weatherproof
- 4 m Ø19 or 25 mm (depending on the pump) double layer delivery hose with adapters in both ends

**Controller features:**

- The GK-7 controller is suitable for the supply control allowing its use only to authorized personnel.
- User and/or vehicle identification through codes and/or identification key
- Supply with or without litre preset.

**It controls:**

- supply hour and date
- Users: 60 or 130 (depending on the model)
- Vehicles
- Supplied litres
- Car mileage (or hours) and consumption
- Stock of the litres in the tank

The services are saved in memory and can be transferred to a computer through the following communication kits:

- via memory key (maximum 100 users)
- via USB/RS-485 cable
- via GSM modem
- via ETHERNET
- via ZIGBEE (wireless)

The query and configuration operation can be done from the computer through the GK-7 software or directly from the supply kit with the code or the identification key, being able to:

- Input or delete users and/or vehicles
- Assign or change the codes or the identification keys of the users and/or vehicles
- Calibrate the supply kit
- Consult the done supplies
- Consult and regularize the tank stock
- Configure the communication and other options of the controller

The control software makes easier:

- The user and vehicle control: Reduction of losses, easy detection of any irregular consumption.
- The control of the car mileage / hours and consumption.
- The purchase and stock control: Avoiding being out of fuel in the tank and controlling the costs exactly.
- Data export: All the data are exported to Excel or .txt (text) files so that they can be used with other programs of the company.
- Password: The software permissions can be limited per user and assign only the required tools for each one of them.
- To assign limits or balances per user: not valid for the communication kit with memory key or multiconsole installations.

↓ **Models**

	Voltage	GK-7 Controller	Automatic nozzle	Flow l/min	
■ COMPACT 50K-60 230	230 VAC	•	PA-60	40-50	28540-CF00000
■ COMPACT 50K-60 12	12 VDC	•	PA-60	35-45	28580-CF00000
■ COMPACT 75K-60 230	230 VAC	•	PA-80	70-80	28640-CF00000
■ COMPACT 90K-60 12	12 VDC	•	PA-80	70-80	28590-CF00000
■ COMPACT 100K-60 230	230 VAC	•	PA-120	75-85	28650-CF00000

**KIT CONFIGURATION:**

\*By default: memory of 60 users/vehicles, identification key reader (iButton)

**USER/VEHICLE MEMORY**

- (•) Memory of 60 users/vehicles · 200 services
- (+) Memory of 130 users/vehicles · 500 services\*  
\*with communication via key max. 100 users/vehicles · 200 services

**OPTIONAL:**

- Pack of 10 identification keys
- Hexagonal pedestal base (height 1m)
- F1" aluminium flange kit (special for COMPACT)

-  
FE007002

251201002  
800400015  
800003029



►\* For the PC connection it is required to acquire a communication kit (page 3)

↓ **Software: included in the communication kit (page 3)**

**Total supply control by user and vehicle:**

• **Manual:** Detailed program instructions

The screenshot shows the software interface with a menu bar (File, Configuration, Operators, Supplies, Vehicles, Users, Stock, Communication, Help) and a sidebar with icons for Supplies, Vehicles, Users, Stock, Communication, and Export. The main window displays a 'SUPPLIES' table with columns: NUMBER, DATE, HOUR, USER, VEHICLE, CONTR., PRODUCT, Km (H.), Liters, PRICE, AMOUNT, CONSUMP., OBS. Below the table, there are summary fields: Supplies: 21, Liters: 6,936,340, Amount: 5,406,34. A 'STOCK' dialog box is open, showing 'DEPOSITO 1' with a '0%' indicator and fields for Capacity (1.000 litres), Level, Considered Litre Value, and Considered Tank Value. Buttons for Input, Regularization, See Register, Movement List, and Recalculate are visible.

**Stock:** Product stock and input control

## Communication Kits

The communication kits have the required elements to communicate the controller to a computer: converter, licence and software.

### COMMUNICATION KIT VIA ZIGBEE-USB (wireless)

#### C/S (client-server) COMMUNICATION KIT VIA ZIGBEE-USB (wireless)

- Wireless communication system
  - It connects the dispenser via radio with a converter in the PC that is connected through a USB port
  - 150 m without barriers
- It includes: ZigBee converter + ZigBee-USB + GK-7 SQL or C/S software

### COMMUNICATION KIT VIA ZIGBEE-ETHERNET (wireless)

#### C/S (client-server) COMMUNICATION KIT VIA ZIGBEE-ETHERNET (wireless)

- Wireless communication system
  - It connects the dispenser via radio with an Ethernet converter that can be connected to any LAN port of the net
  - 150 m without barriers
- It includes: ZigBee converter + ZigBee-Ethernet + GK-7 SQL or C/S software

### COMMUNICATION KIT VIA MEMORY KEY (iButton)

#### C/S (client-server) COMMUNICATION KIT VIA MEMORY KEY (iButton)

- The memory key is placed in the controller reader to automatically upload and load the data. PC connection through USB converter.
- It includes: USB converter + memory key + GK-7 SQL or C/S software  
*(\*Limited to 100 users and 200 services in memory)*

### COMMUNICATION KIT VIA USB CABLE

#### C/S (client-server) COMMUNICATION KIT VIA USB CABLE

- It is required a 4x0.25 m communication cable between the PC and the controller.
  - Max. distance: 1000 m
- It includes: 485/USB cable converter + GK-7 SQL or C/S software

### COMMUNICATION KIT VIA ETHERNET CABLE

#### C/S (client-server) COMMUNICATION KIT VIA ETHERNET CABLE

- It allows connecting the controller to the computing network as if it was another PC more in the installation. It is required a 4x0.25 m communication cable between the converter and the controller. Max. distance: 1000 m. It allows the connection in Wi-fi, VPN or WAN.
- It includes: ETHERNET converter + GK-7 SQL or C/S software

### COMMUNICATION KIT VIA GSM

#### C/S (client-server) COMMUNICATION KIT VIA GSM

- The communication is made through SMS messages. A data SIM card must be installed in each and every one of the modems (not included).
- It includes: GSM converter for the dispenser + GK-7 SQL or C/S software  
 It is required to have a GSM MODEM in the PC.

#### GSM MODEM converter for PC

#### Converters and additional accessories:

- Memory key (red)
- 4x0.25 m shielded cable
- CONTINET PG-9 protection tube (m)
- GK-7 additional licence (multistation)
- GK-7 C/S (client-server) additional licence
- Memory key converter (it is used to identify the identification keys in the PC)
- 485/USB cable converter
- LAN/RS485 Ethernet converter
- GSM/RS485 GK-7 converter
- GSM PC converter
- Set of 2 ZigBee-USB (wireless) converters
- Set of 2 Zigbee-Ethernet (wireless) converters

257180000  
257600700

257190000  
257600500

257120000  
257600200

257160000  
257600100

257130000  
257600300

257140000  
257600400

251208020

251201001  
800902001  
807609004  
257150000  
257600600  
251208003  
251208032  
251208001  
252208001  
251208020  
251208046  
251208047

257500000

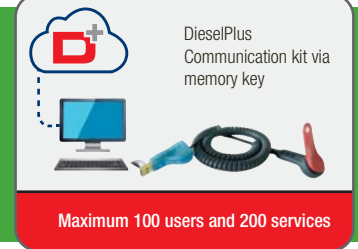
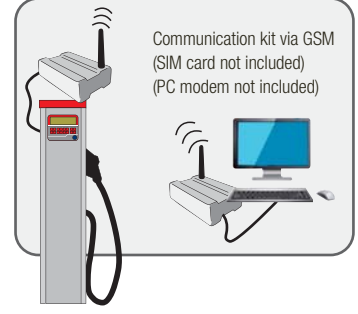
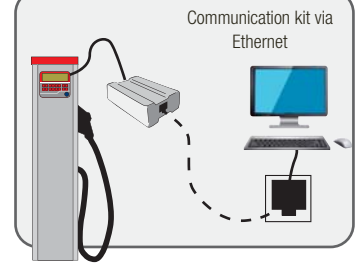
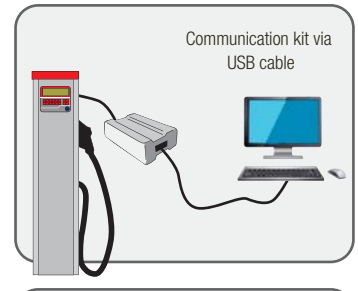
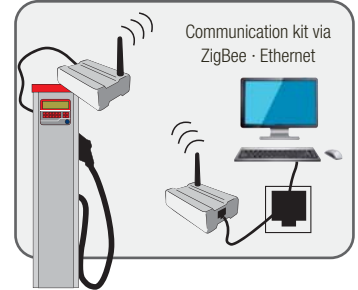
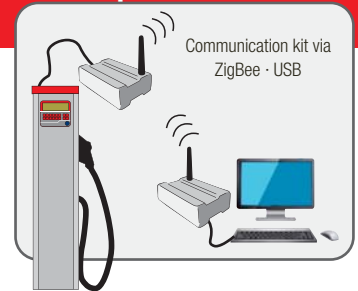

### GK-7 & GK-7M COMMUNICATION KITS with DIESELPLUS (web service)

#### DIESELPLUS COMMUNICATION KIT VIA MEMORY KEY

- It allows the GK-7 and GK-7M connection to the web service site DieselPlus. Memory key: It is placed in the controller reader in order to automatically upload and load the data. PC connection through USB converter.
- It includes: USB converter + memory key + 1-year DieselPlus Fee  
*(\*Limited to 100 users and 200 services in memory)*